

For Lease

9879 Chartwell Drive
Dallas, Texas
8,240 Square Feet

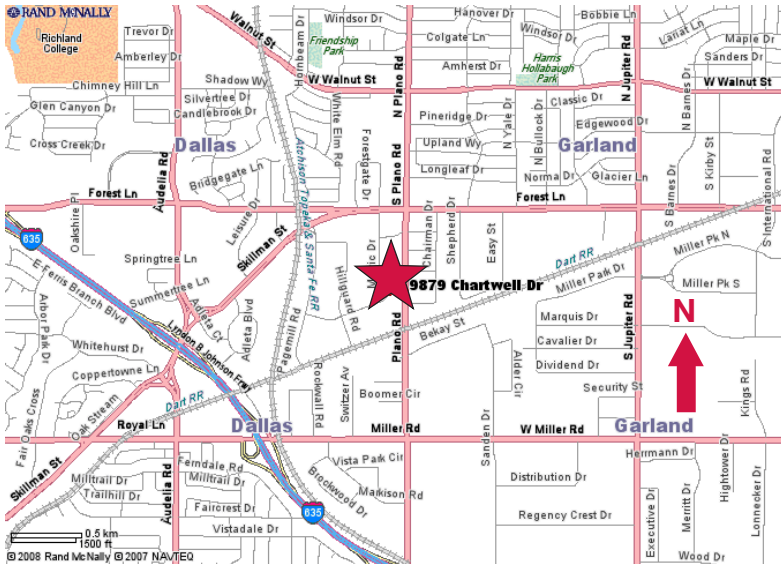

- ± 2,464 SF Office
- ± 16' Clear Height
- 1 Dock Well
- 1 Grade Level Door
- Fenced Storage Area
- Endcap



Commercial Real Estate Services, Worldwide.

contact information:

Stephen Cooper

NAI Robert Lynn
direct 214 256 7160
fax 214 256 7101
email scooper@robertlynn.com

John Lancaster

NAI Robert Lynn
direct 214 256 7162
fax 214 256 7101
email jlancaster@robertlynn.com

For Lease

9879 Chartwell Drive
Dallas, Texas
8,240 Square Feet

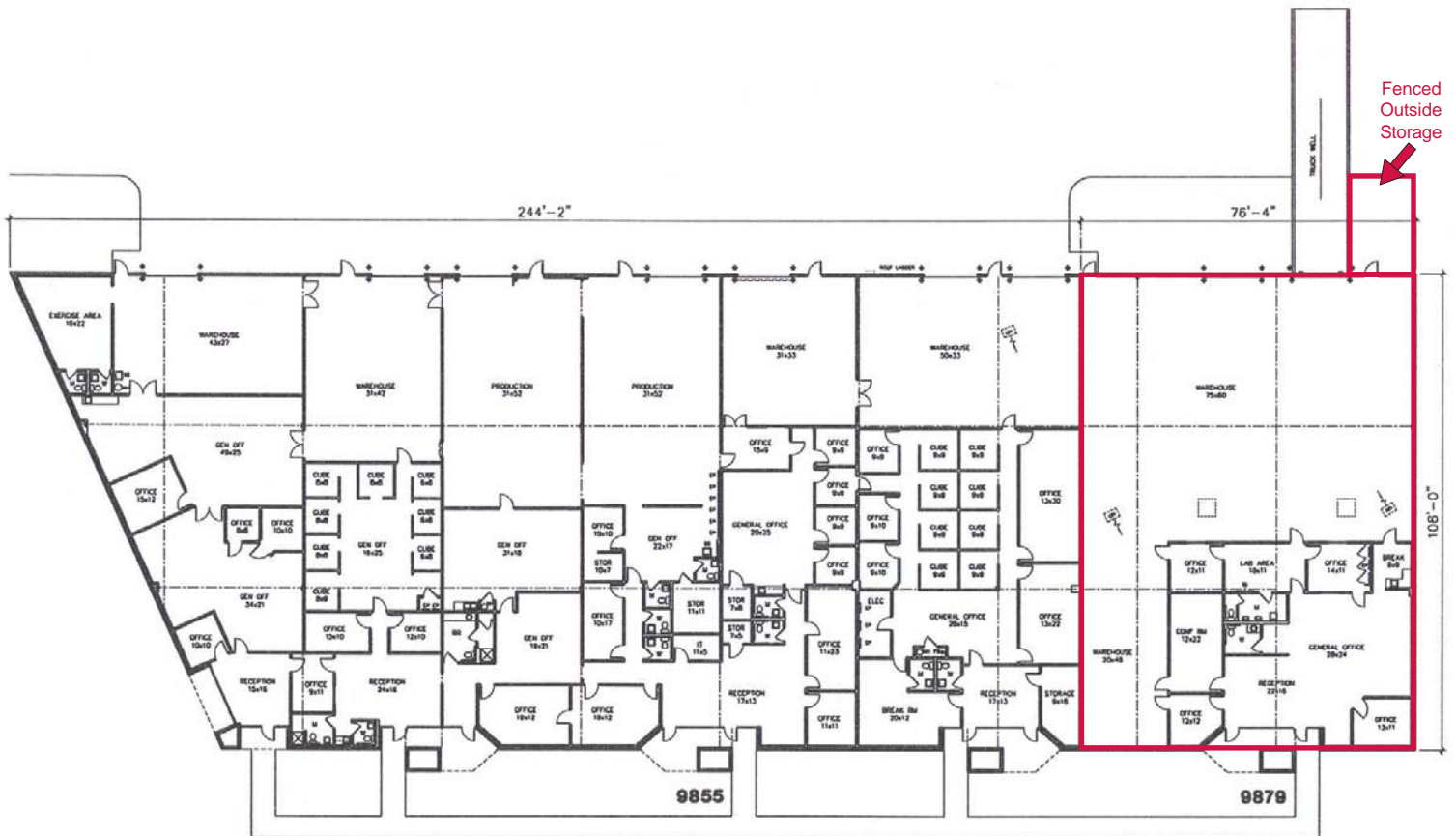

contact information:

Stephen Cooper

NAI Robert Lynn
direct 214 256 7160
fax 214 256 7101
email scooper@robertlynn.com

John Lancaster

NAI Robert Lynn
direct 214 256 7162
fax 214 256 7101
email jlancaster@robertlynn.com

NAI Robert Lynn
Commercial Real Estate Services, Worldwide.

Individual Memberships
SOCIETY OF
INDUSTRIAL AND
OFFICE REALTORS®