

For Lease

910 Avenue M
Grand Prairie, Texas
5,000 Square Feet

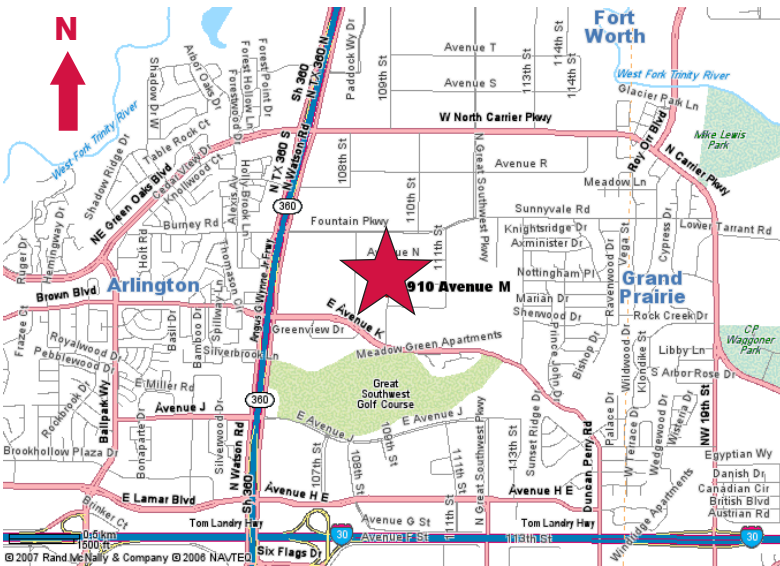

- ± 680 SF Office
- ± 16' Clear Height
- 1 Dock High Door
- ± 110' Truck Court Depth
- Heavy Power
- ± 18 Car Parks
- Endcap



NAI Robert Lynn

Commercial Real Estate Services, Worldwide.

contact information:

Michael A. Stanzel, SIOR

NAI Robert Lynn

direct 214 256 7122

fax 214 256 7101

email mstanzel@robertlynn.com

