

For Sublease

789 Grove Road #115

Richardson, Texas

7,274 Square Feet



- ± 2,200 SF Office
- ± 20' Clear Height
- 1 Dock High Door
- 1 Ramped Door
- Long-Term Lease Available
- Sublease Through September 30, 2012

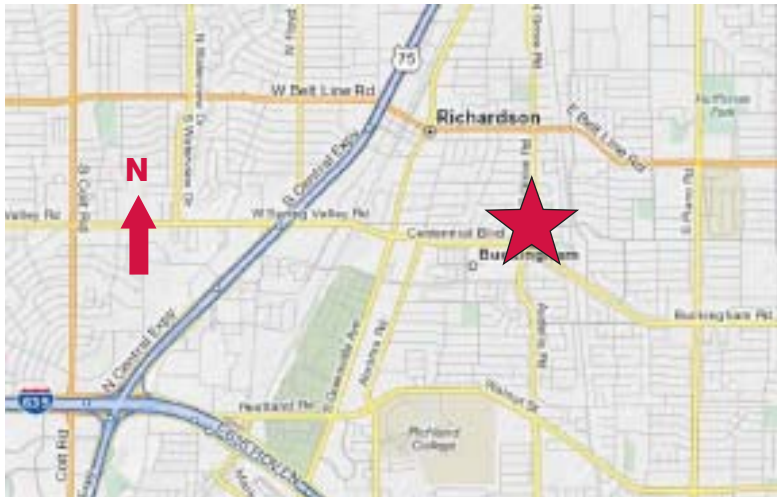

NAI Robert Lynn

Commercial Real Estate Services, Worldwide.

contact information:

Dave Peterson

NAI Robert Lynn

direct 214 256 7129

fax 214 256 7101

email dpeterson@robertlynn.com

For Sublease

789 Grove Road #115

Richardson, Texas

7,274 Square Feet

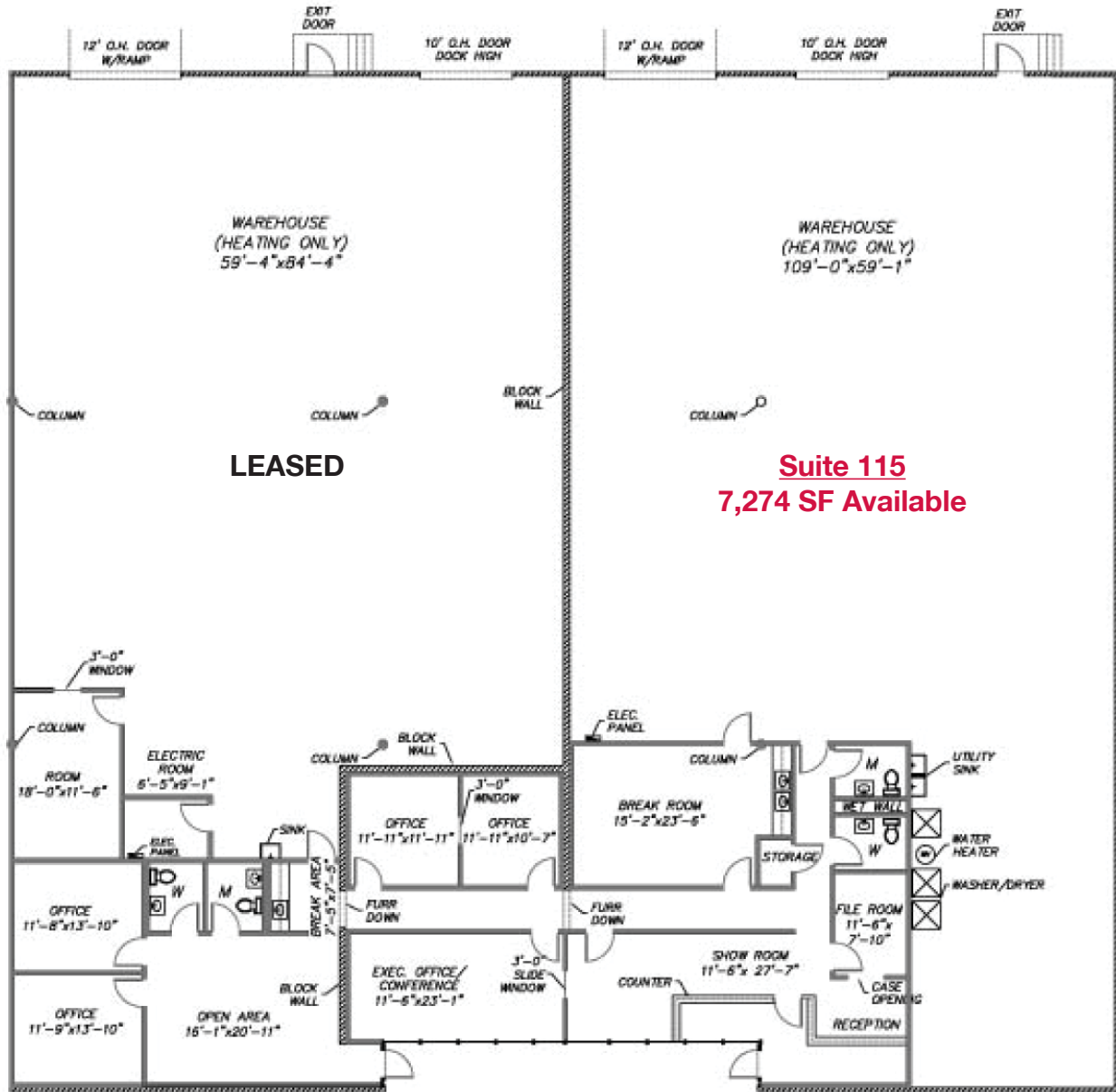

Commercial Real Estate Services, Worldwide.

The information contained herein has been given to us by the owner of the property or other sources we deem reliable. We have no reason to doubt its accuracy, but we do not guarantee it. All information should be verified prior to purchase or lease.

