

# For Lease

777 Freeport Parkway

Coppell, Texas

18,000 - 43,132 Square Feet Available



- 8:1000 Parking
- Nicely Landscaped With Water Feature
- Great Access to DFW Airport, I-635 & SH 121
- Across From Hard Eight BBQ

Owned by:



Leased by:



Commercial Real Estate Services, Worldwide.

contact information:

**Rick Medinis, SIOR**

direct 214 256 7116

email rmedinis@robertlynn.com

**John Lancaster**

direct 214 256 7162

email jlancaster@robertlynn.com

**Tyson Erwin**

direct 214 256 7127

email terwin@robertlynn.com

# For Lease

777 Freeport Parkway

Coppell, Texas

18,000 - 43,132 Square Feet Available

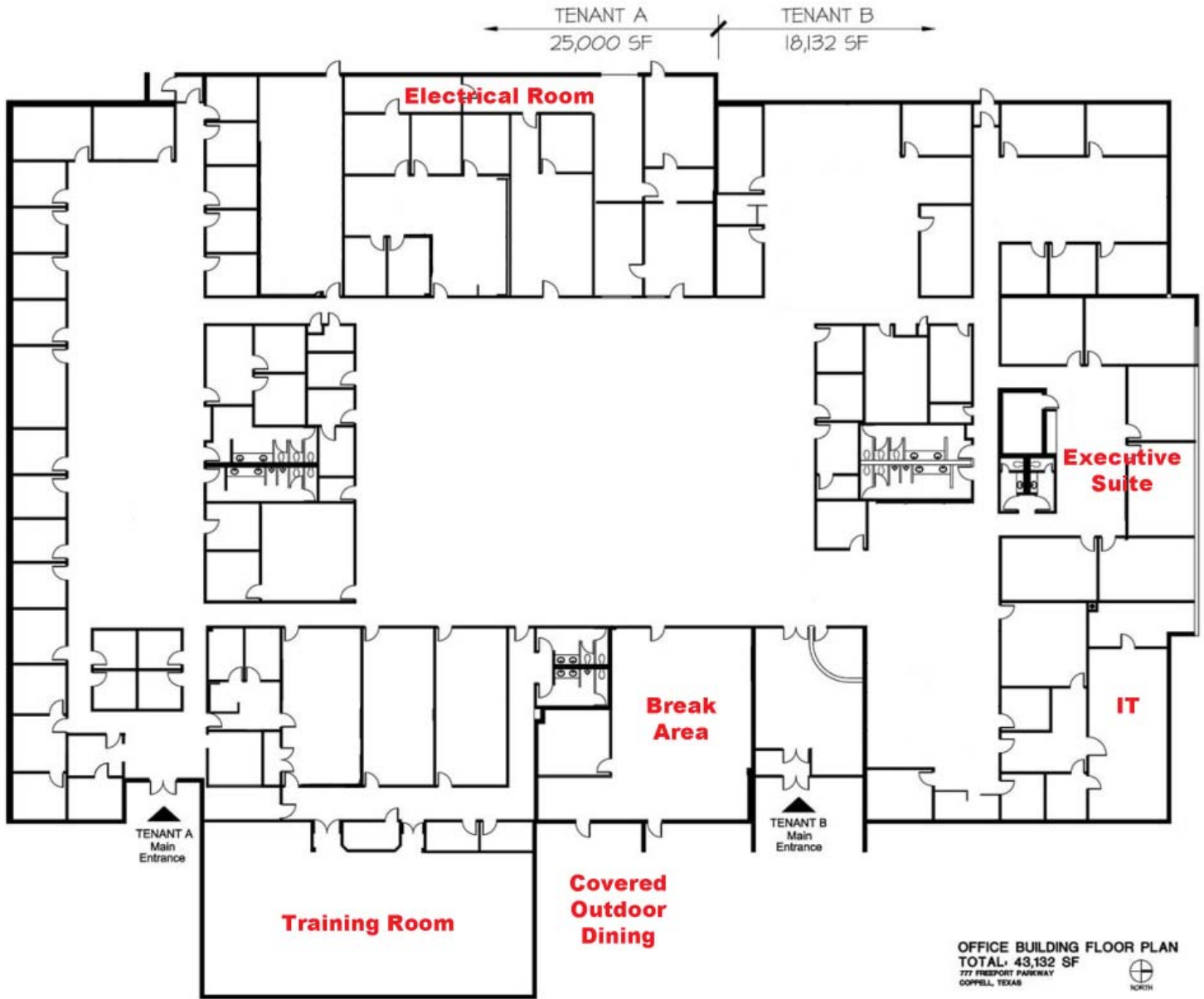

Commercial Real Estate Services, Worldwide.

The information contained herein has been given to us by the owner of the property or other sources we deem reliable. We have no reason to doubt its accuracy, but we do not guarantee it. All information should be verified prior to purchase or lease.

