

FOR LEASE 2,164 SF



→ OVERVIEW

7356 Dogwood Park offers 2,164 square feet in Midway Business Park

- Available 9/1/2010
- Prime location, with easy access to Highway 121 and Loop 820
- Professionally owned and managed

→ PROPERTY STATISTICS

Available SF	2,164 square feet
Office Build-out	567 square feet
Number of Doors	1 grade level door
Ceiling Height	14' clear
Location	Convenient access to Airport Freeway, Loop 820, and I-30

7356 Dogwood Park Richland Hills, TX

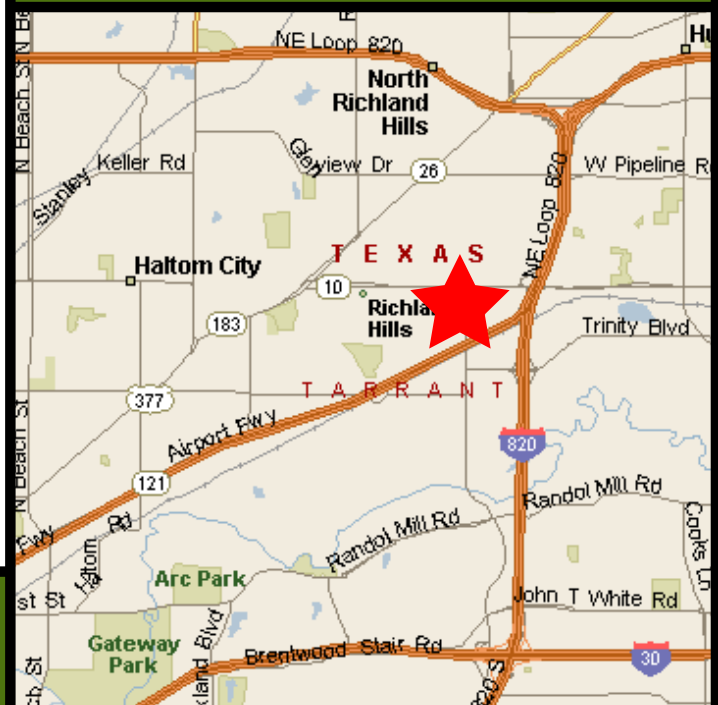

www.firstindustrial.com

FIRST INDUSTRIAL REALTY TRUST
4505 Excel Parkway Suite 600 Addison, TX 75001
T: (972) 386-4700 F: (972) 386-4540 www.firstindustrial.com



7356 Dogwood Park
Richland Hills, TX 76118

FOR LEASE 2,164 SF

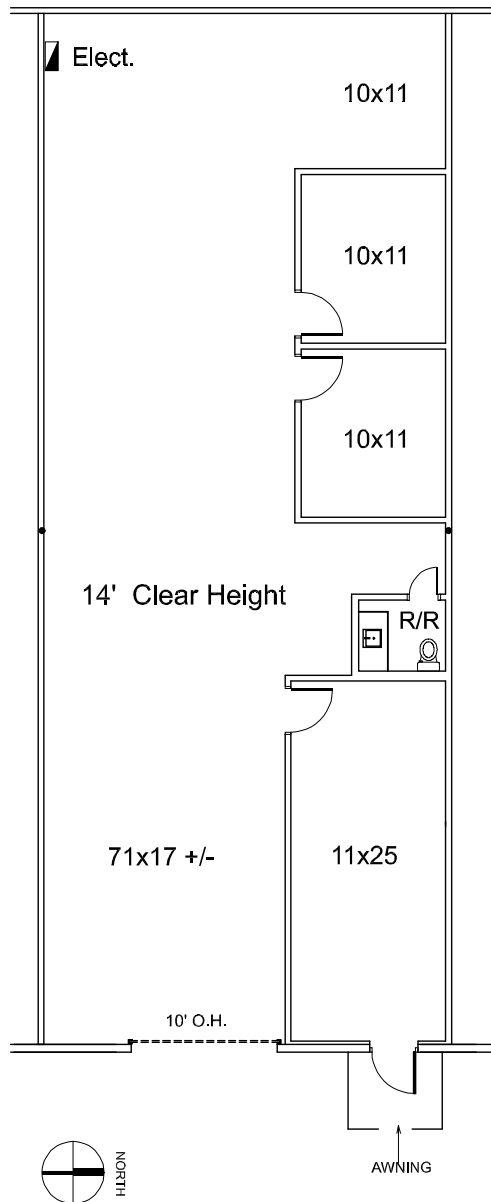

→ CONTACT

our exclusive agent:



Todd Hubbard, SIOR
Executive Vice President
(817) 885-8333, Ext. 112
thubbard@robertlynn.com

Michael Newsome
Associate
(817) 885-8333, Ext. 165
mnewsome@robertlynn.com

NAI Robert Lynn
4851 LBJ Freeway
Suite 1000
Dallas, TX 75244
(214) 256-7100

All information furnished regarding the property for sale, rental or financing is obtained from sources deemed reliable. No representation is made to the accuracy thereof and is submitted subject to errors, omissions, change of price rental or other conditions, prior sale, lease, or financing, or withdrawal without notice. First Industrial Realty Trust, Inc. represents the Seller in this transaction and as such owes all duties and obligations thereto.

FIRST INDUSTRIAL REALTY TRUST
4505 Excel Parkway Suite 600 Addison, TX 75001
T: (972) 386-4700 F: (972) 386-4540 www.firstindustrial.com

