

# FOR LEASE 2,088 SF

## → OVERVIEW

7348 Dogwood Park is located in Midway Business Park

-- Available 10/1/10

-- Prime location, right off Highway 121, with access to Loop 820, and I-35W



## → PROPERTY STATISTICS

<b>Available SF</b>	2,088 square feet
<b>Office Area</b>	203 square feet
<b>Number of Docks</b>	1 grade level door
<b>Parking Facilities</b>	Abundant parking
<b>Clear Height</b>	14' clear
<b>Location</b>	Convenient access to SH-183, I-35W, Loop 820, and DFW Airport

[www.firstindustrial.com](http://www.firstindustrial.com)

## 7348 Dogwood Park Richland Hills, TX

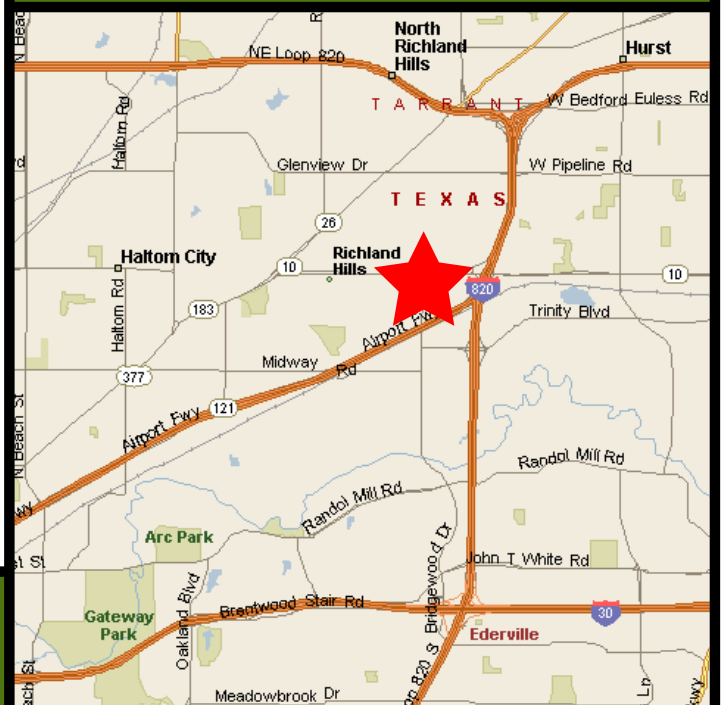

### FIRST INDUSTRIAL REALTY TRUST

4505 Excel Parkway Suite 600 Addison, TX 75001

T: (972) 386-4700 F: (972) 386-4540 [www.firstindustrial.com](http://www.firstindustrial.com)



7348 Dogwood Park  
Richland Hills, TX

FOR LEASE 2,088 SF

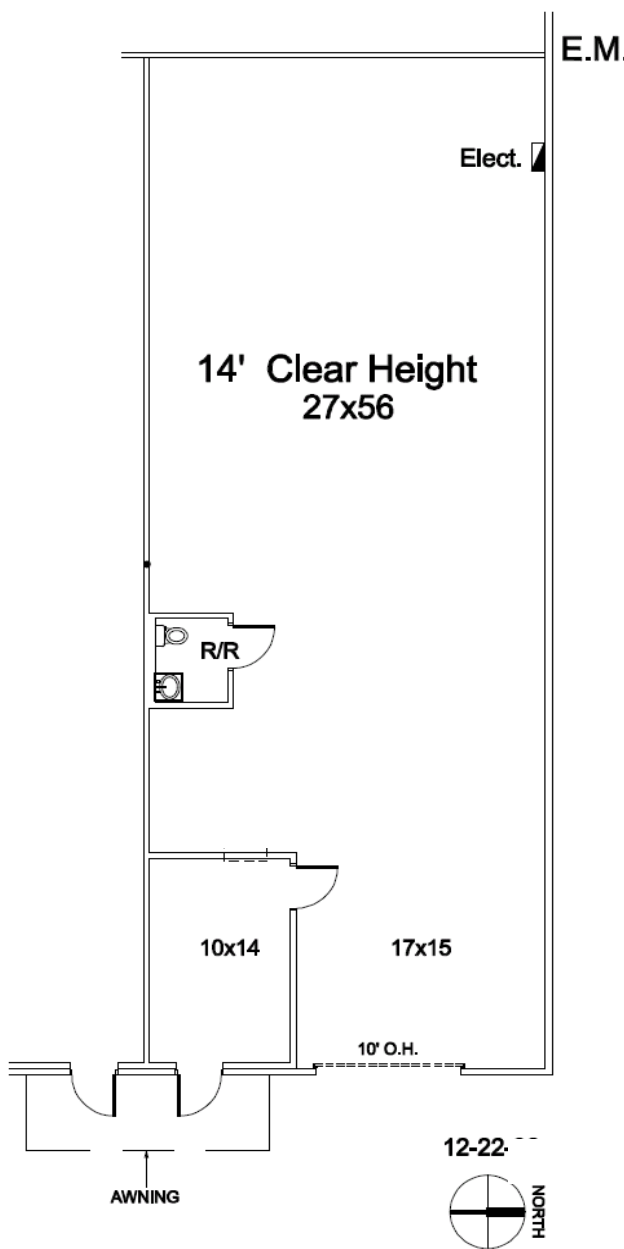

2,088 S.F. Total / 203 S.F. Office

→ CONTACT

our exclusive agent:

**NAI Robert Lynn**  
Commercial Real Estate Services, Worldwide.

**Todd Hubbard, SIOR**

Executive Vice President  
(817) 885-8333, Ext. 112  
thubbard@robertlynn.com

**Michael Newsome**

Associate  
(817) 885-8333, Ext. 165  
mnewsome@robertlynn.com

**NAI Robert Lynn**

4851 LBJ Freeway  
Suite 1000  
Dallas, TX 75244  
(214) 256-7100

All information furnished regarding the property for sale, rental or financing is obtained from sources deemed reliable. No representation is made to the accuracy thereof and is submitted subject to errors, omissions, change of price rental or other conditions, prior sale, lease, or financing, or withdrawal without notice. First Industrial Realty Trust, Inc. represents the Seller in this transaction and as such owes all duties and obligations thereto.

**FIRST INDUSTRIAL REALTY TRUST**

4505 Excel Parkway Suite 600 Addison, TX 75001

T: (972) 386-4700 F: (972) 386-4540 www.firstindustrial.com

