

FOR SALE OR LEASE 17,600 SF



→ OVERVIEW

7339-7345 Tower Street is located in Midway Business Park

- Prime location, right off Highway 121, with access to Loop 820, and I-35W
- Outside fenced storage area

→ PROPERTY STATISTICS

Available SF	17,600 square feet
Office Area	3,116 square feet
Number of Docks	6 dock doors
Clear Height	18'
Parking Facilities	Abundant parking
Location	Prime location, right off Highway 121, with access to Loop 820 and I-35W

7339-7345 Tower Street Richland Hills, TX

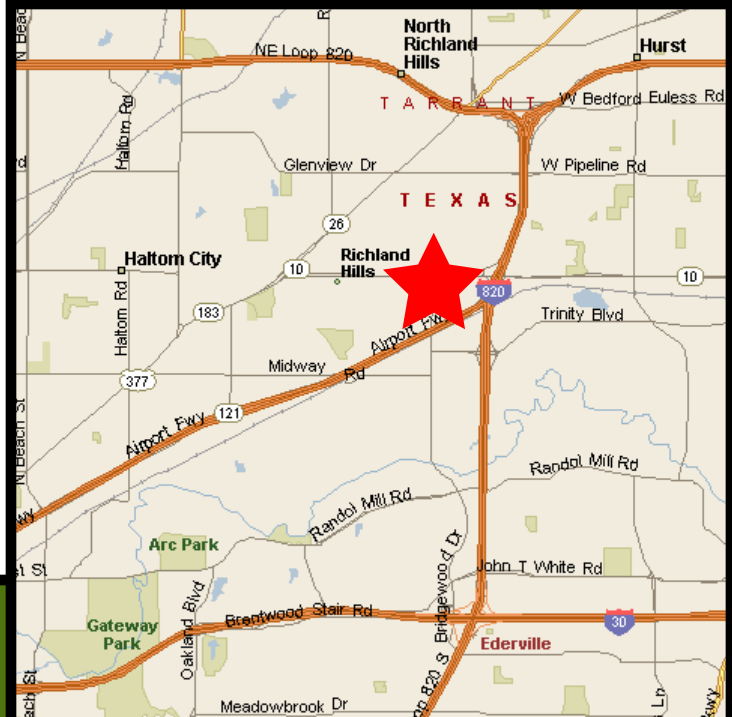

www.firstindustrial.com

FIRST INDUSTRIAL REALTY TRUST

4505 Excel Parkway Suite 600 Addison, TX 75001

T: (972) 386-4700 F: (972) 386-4540 www.firstindustrial.com



7339-7345 Tower Street
Richland Hills, TX

FOR SALE OR LEASE 17,600 SF

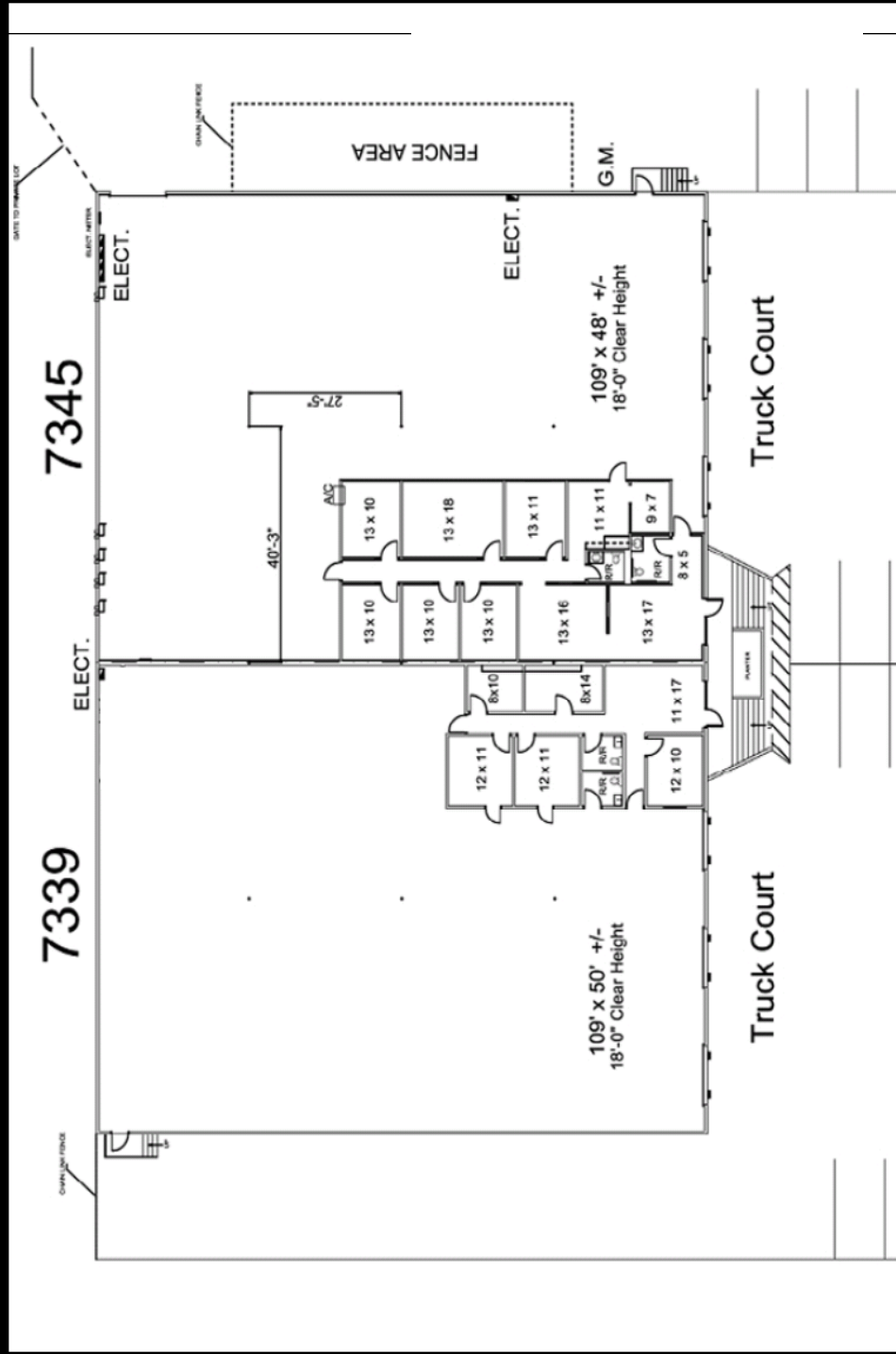

→ CONTACT

our exclusive agent:

NAI Robert Lynn
Commercial Real Estate Services, Worldwide.

Todd Hubbard, SIOR
Executive Vice President
(817) 885-8333, Ext. 112
thubbard@robertlynn.com

Michael Newsome
Associate
(817) 885-8333, Ext. 165
mnewsome@robertlynn.com

NAI Robert Lynn
4851 LBJ Freeway
Suite 1000
Dallas, TX 75244
(214) 256-7100

All information furnished regarding the property for sale, rental or financing is obtained from sources deemed reliable. No representation is made to the accuracy thereof and is submitted subject to errors, omissions, change of price rental or other conditions, prior sale, lease, or financing, or withdrawal without notice. First Industrial Realty Trust, Inc. represents the Seller in this transaction and as such owes all duties and obligations thereto.

FIRST INDUSTRIAL REALTY TRUST
4505 Excel Parkway Suite 600 Addison, TX 75001
T: (972) 386-4700 F: (972) 386-4540 www.firstindustrial.com

