

For Lease

6400 & 6428 Wuliger Way
North Richland Hills, Texas
4,800 - 12,800 Square Feet



6400 Wuliger Way

- 12,800 Square Feet
- Build-To-Suit Office
- ± 18' Clear Height
- 1 Dock High Door (With Leveler)
- Sprinklered

6428 Wuliger Way

- 4,800 Square Feet
- ± 750 SF Office
- ± 18' Clear Height
- 1 Ramp
- 1 Dock Personnel Door
- Sprinklered

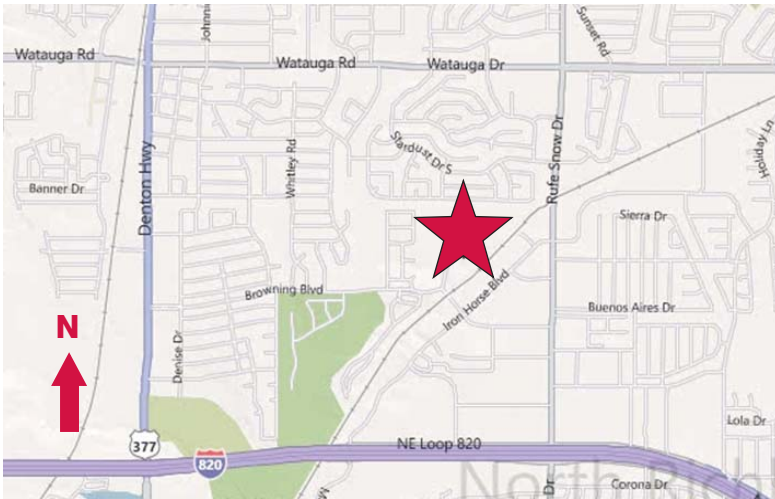

NAI Robert Lynn

Commercial Real Estate Services, Worldwide.

contact information:

Todd Hubbard, SIOR

NAI Robert Lynn

direct 817 872 3901

email thubbard@robertlynn.com

Michael Newsome

NAI Robert Lynn

direct 817 872 3903

email mnewsome@robertlynn.com



For Lease

6400 & 6428 Wuliger Way
North Richland Hills, Texas
4,800 - 12,800 Square Feet

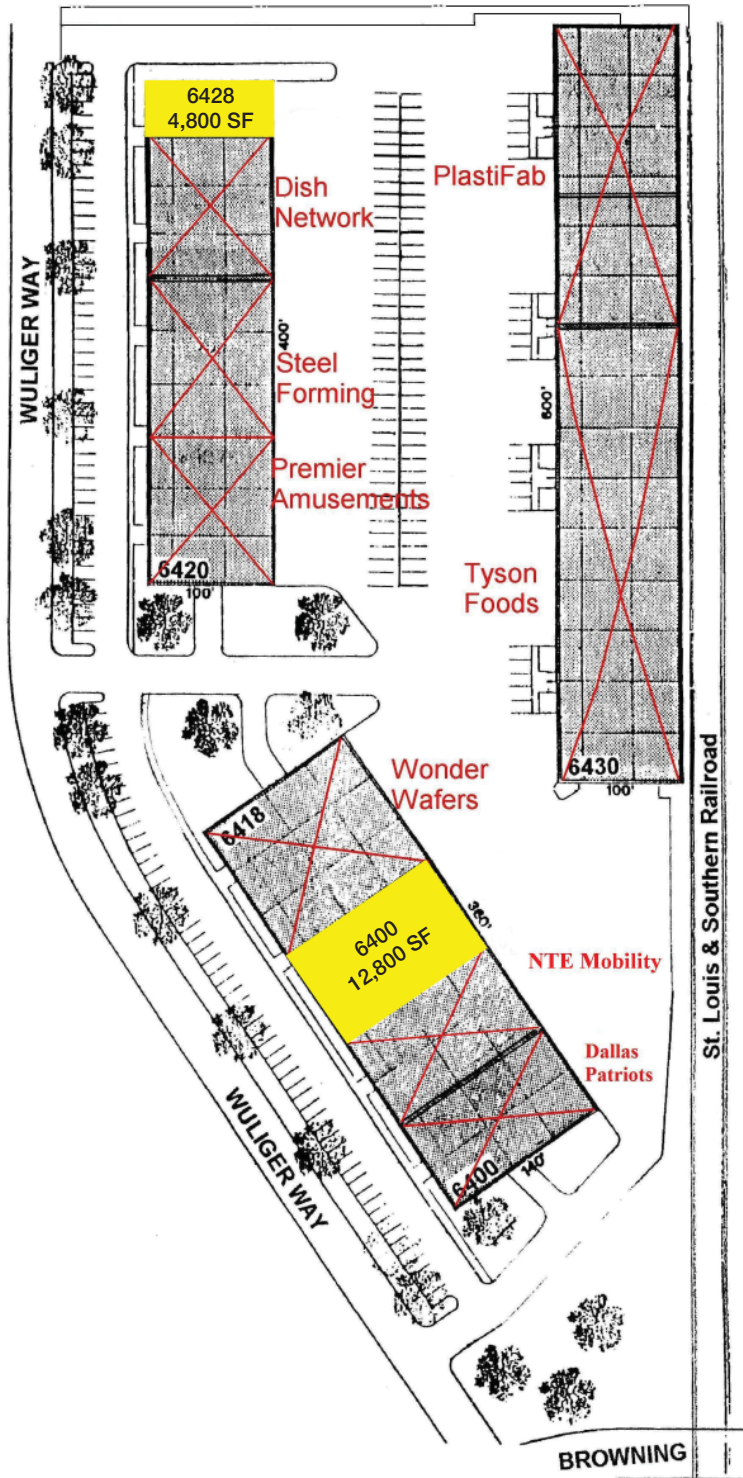

NAI Robert Lynn

Commercial Real Estate Services, Worldwide.

The information contained herein has been given to us by the owner of the property or other sources we deem reliable. We have no reason to doubt its accuracy, but we do not guarantee it. All information should be verified prior to purchase or lease.

Individual Memberships
SOCIETY OF
INDUSTRIAL AND
OFFICE REALTORS®