



4851 LBJ Freeway

Suite 1050

Dallas, Texas

± 2,500 Square Feet For Sublease

- Shell Space With Generous Tenant Improvement Dollars
- Elevator Exposure
- Covered Parking
- On-Site Management & Security
- Exercise Facility, Deli
- Sublease Through 2013
- Great Location Near Galleria at I-635 & Dallas North Tollway

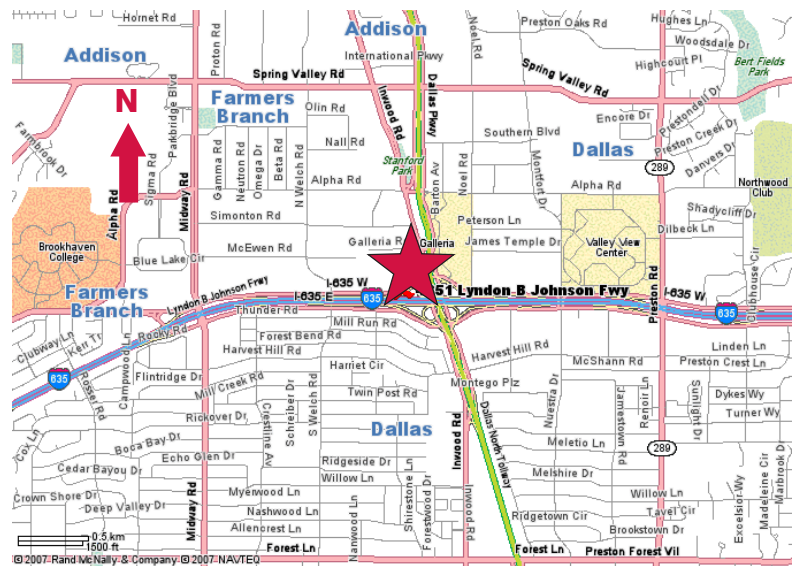

NAI Robert Lynn

Commercial Real Estate Services, Worldwide.

contact information:

Jon Rymsza

NAI Robert Lynn

direct 214 256 7153

fax 214 256 7101

email jrymsza@robertlynn.com

4851 LBJ Freeway

Suite 1050

Dallas, Texas

± 2,500 Square Feet For Sublease

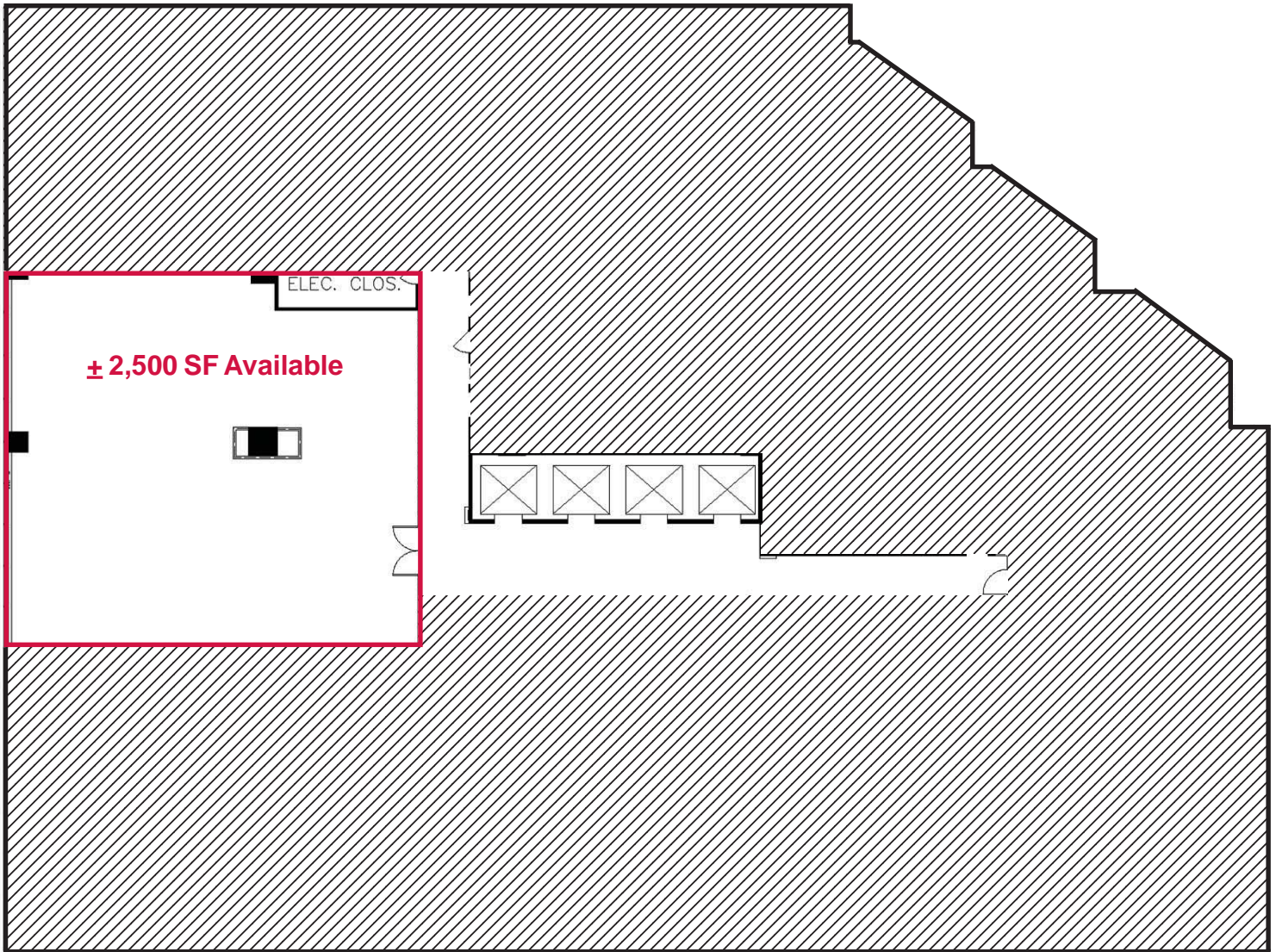

NAI Robert Lynn
Commercial Real Estate Services, Worldwide.

 Individual Memberships
SOCIETY OF
INDUSTRIAL AND
OFFICE REALTORS®

contact information:

Jon Rymza

NAI Robert Lynn

direct 214 256 7153

fax 214 256 7101

email jrymsza@robertlynn.com

The information contained herein has been given to us by the owner of the property or other sources we deem reliable. We have no reason to doubt its accuracy, but we do not guarantee it. All information should be verified prior to purchase or lease.