

For Lease

3226 Skylane Drive

Carrollton, Texas

15,859 Square Feet



- ± 2,625 SF Office
- ± 20' Clear Height
- 3 Dock High Doors (1 Ramped)
- Sprinklered
- ± 5,000 SF Outside Storage
- 12 Car Parks

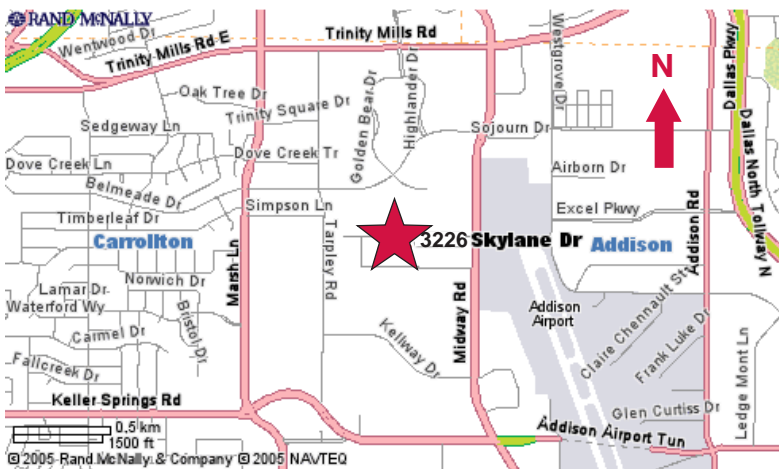

contact information:

Mark Miller, SIOR

NAI Robert Lynn

direct 214 256 7119

fax 214 256 7101

email mmiller@robertlynn.com

Chad Albert

NAI Robert Lynn

direct 214 256 7135

fax 214 256 7101

email calbert@robertlynn.com

Becky Miller

NAI Robert Lynn

direct 214 256 7107

fax 214 256 7101

email bmiller@robertlynn.com

NAI Robert Lynn

Commercial Real Estate Services, Worldwide.

For Lease

3226 Skylane Drive
Carrollton, Texas
15,859 Square Feet

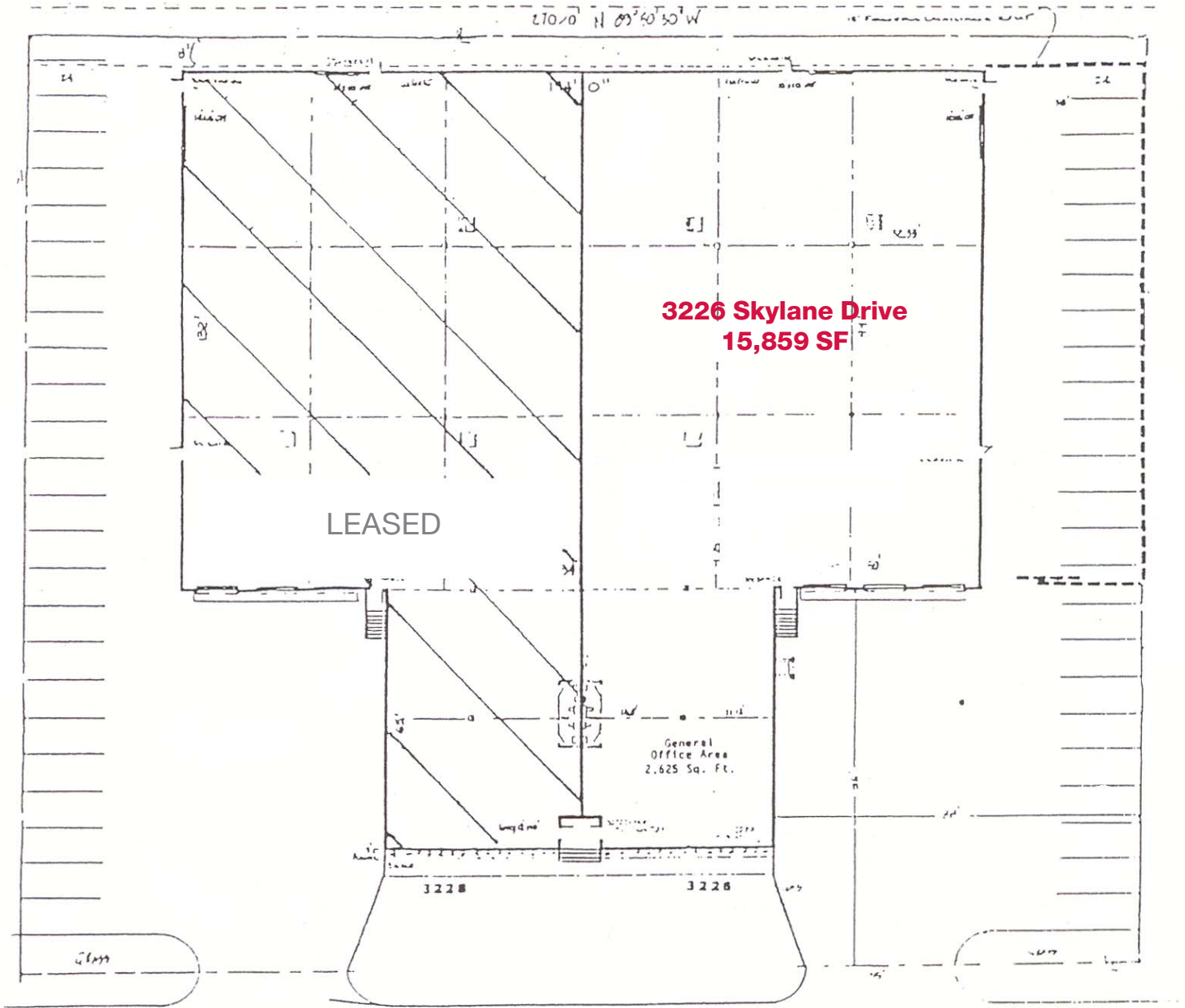

NAI Robert Lynn
Commercial Real Estate Services, Worldwide.

The information contained herein has been given to us by the owner of the property or other sources we deem reliable. We have no reason to doubt its accuracy, but we do not guarantee it. All information should be verified prior to purchase or lease.

Individual Memberships
SIOR SOCIETY OF
INDUSTRIAL AND
OFFICE REALTORS®