

Market III

2745 Market Street, Suite 100, Garland, Texas



Building Highlights

- Premier Northeast Dallas Location: Near Shiloh & Kingsley
- End Cap Space
- 31,449 SF
- 1,291 SF of Office
- Sprinklered
- 600A / 480V / 3 Phase
- Fenced Outside Storage
- 6 Dock High Loading Doors
- 1 Ramped Door
- 1 Grade Level Door
- Clear Height: 19'

For more information

Stephen Cooper, SIOR, NAI Robert Lynn

Tel. 214.256.7100 | scooper@robertlynn.com

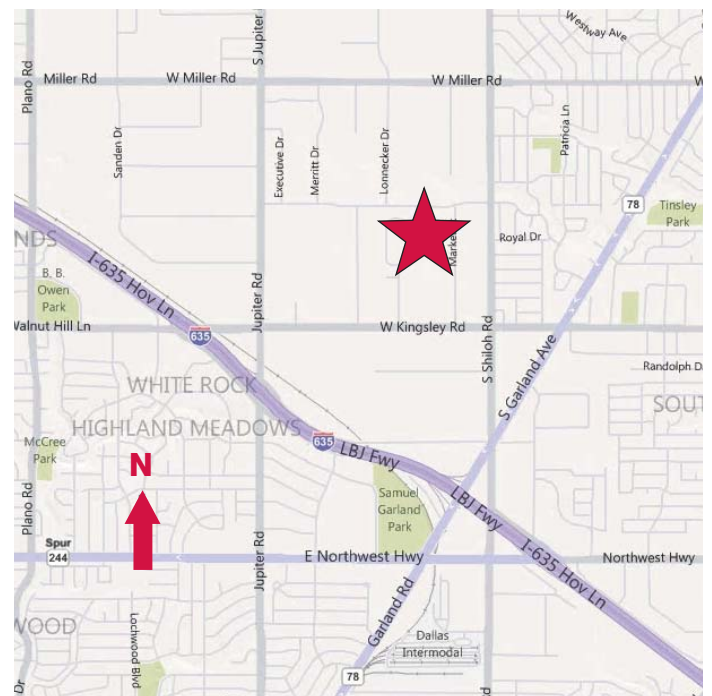

Market III

2745 Market Street, Suite 100, Garland, Texas

