

For Lease

2626 Northaven Road
Dallas, Texas
16,560 Square Feet Available

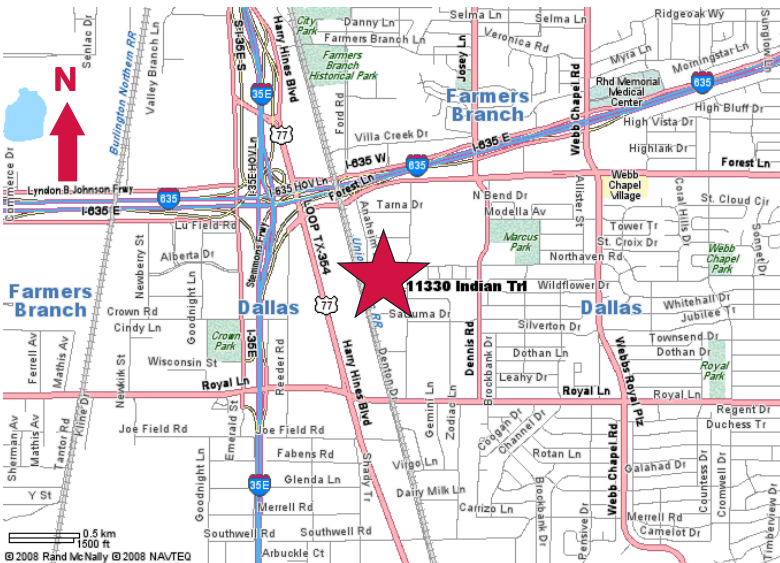

- ± 704 SF Office
- ± 22' Clear Height
- 3 Dock Doors (1 Ramped)
- 36' x 38'4" Column Spacing
- Sprinklered
- Heavy Power
- SE Quadrant I-35 & I-635 / Near Dart Rail

Owned & Managed By:



INDUSTRIAL PROPERTIES
CORPORATION

contact information:

Chad Albert

NAI Robert Lynn

direct 214 256 7135

email calbert@robertlynn.com

Matt Elliott

NAI Robert Lynn

direct 214 256 7161

email melliott@robertlynn.com

NAI Robert Lynn

Commercial Real Estate Services, Worldwide.

For Lease

2626 Northaven Road

Dallas, Texas

16,560 Square Feet Available

