

# For Lease

2202 Manana Drive

Dallas, Texas

3,375 - 22,500 Square Feet Available

**ZONED FOR  
CAR  
MECHANICS!**



- Brand New Construction
- ± 20' Clear Height
- Grade Level Loading
- 75' x 15' Pull Through Bays
- Floor Drains
- Sprinklered
- ± 20 Acres Fenced Tractor Trailer Parking
- Video Surveillance
- Large Truck Court
- Great Access to I-35E

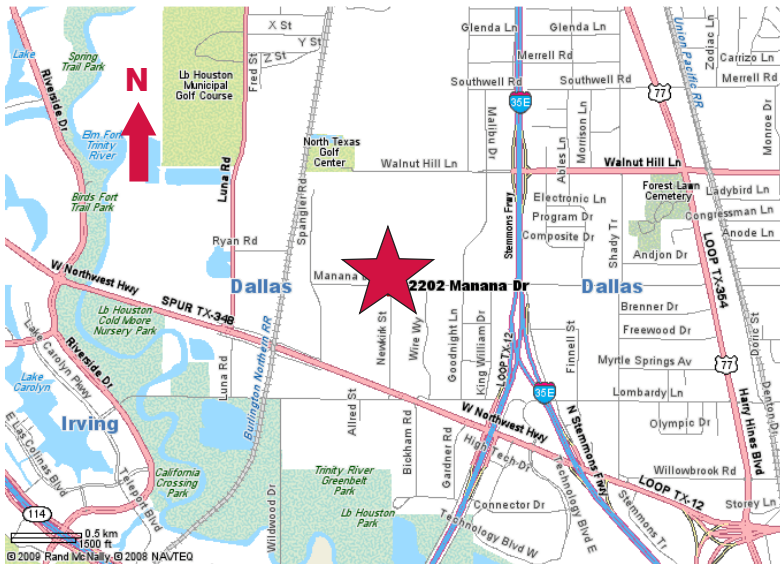

#### contact information:

**Robert Blankinship**

NAI Robert Lynn

direct 214 256 7115

fax 214 256 7101

email [rblankinship@robertlynn.com](mailto:rblankinship@robertlynn.com)

**James C. Collins**

NAI Robert Lynn

direct 214 256 7128

fax 214 256 7101

email [jcollins@robertlynn.com](mailto:jcollins@robertlynn.com)

**NAI Robert Lynn**

Commercial Real Estate Services, Worldwide.

# For Lease

2202 Manana Drive

Dallas, Texas

3,375 - 22,500 Square Feet Available



**NAI** Robert Lynn

Commercial Real Estate Services, Worldwide.

The information contained herein has been given to us by the owner of the property or other sources we deem reliable. We have no reason to doubt its accuracy, but we do not guarantee it. All information should be verified prior to purchase or lease.



Individual Memberships  
SOCIETY OF  
INDUSTRIAL AND  
OFFICE REALTORS®