

# For Sublease

2115 W. Valley View Lane

Farmers Branch, Texas

40,000 - 79,379 Square Feet Available



- ± 5,000 SF Office
- ± 21' Clear Height
- Up to 14 Dock High Doors (1 Ramped & 1 With Leveler)
- Sprinklered
- Heavy Power
- ± 40 Car Parks
- Easy Access to I-35E & I-635
- Sublease Through December 31, 2016

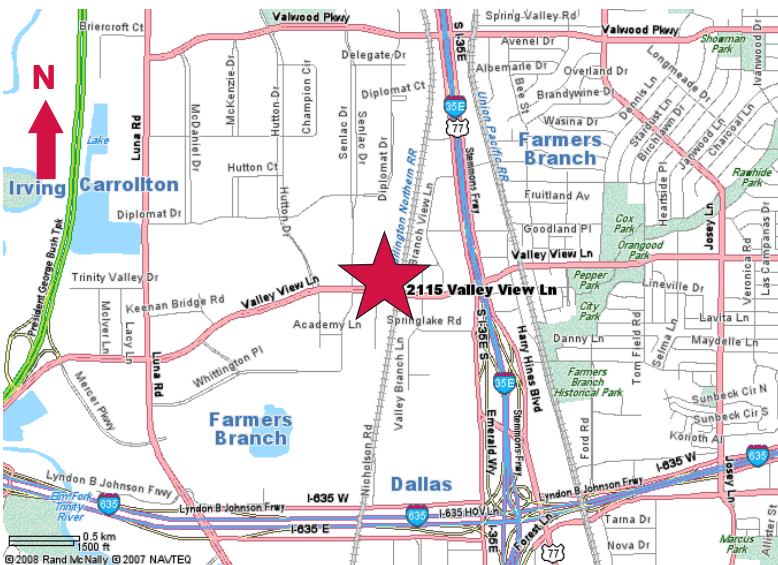

contact information:

**Mark Miller, SIOR**

NAI Robert Lynn

direct 214 256 7119

fax 214 256 7101

email [mmiller@robertlynn.com](mailto:mmiller@robertlynn.com)

**Chad Albert**

NAI Robert Lynn

direct 214 256 7135

fax 214 256 7101

email [calbert@robertlynn.com](mailto:calbert@robertlynn.com)

**Becky Miller**

NAI Robert Lynn

direct 214 256 7107

fax 214 256 7101

email [bmiller@robertlynn.com](mailto:bmiller@robertlynn.com)

**NAI Robert Lynn**

Commercial Real Estate Services, Worldwide.

# For Sublease

2115 W. Valley View Lane

Farmers Branch, Texas

40,000 - 79,379 Square Feet Available

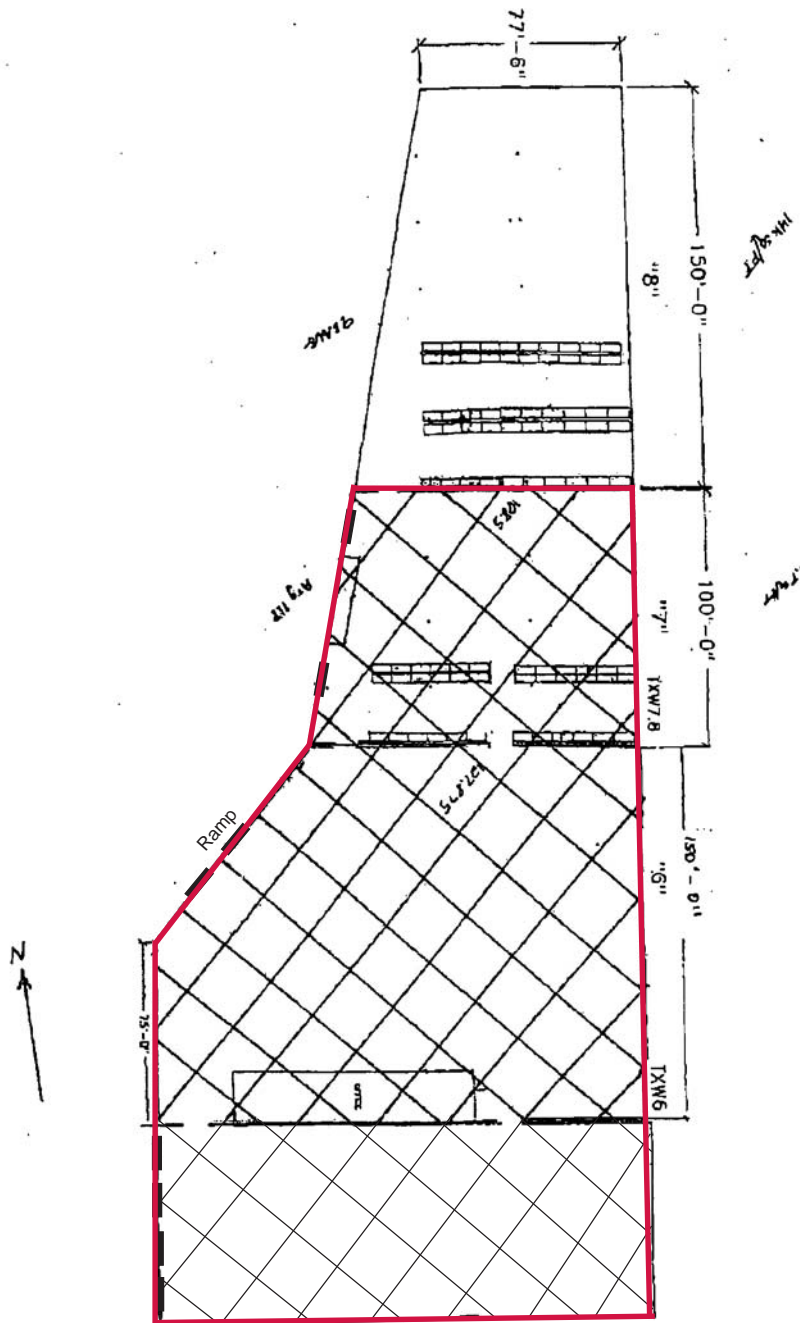

## NAI Robert Lynn

Commercial Real Estate Services, Worldwide.

The information contained herein has been given to us by the owner of the property or other sources we deem reliable. We have no reason to doubt its accuracy, but we do not guarantee it. All information should be verified prior to purchase or lease.

Individual Memberships  
SOCIETY OF  
INDUSTRIAL AND  
OFFICE REALTORS®