

# FOR LEASE 14,849 SF



## → OVERVIEW

1628 Terre Colony Court is located in the Lone Star Business Park in South Dallas:

- Available Immediately
- Abundant Parking
- Heavy Power

## → PROPERTY STATISTICS

<b>Available SF</b>	14,849 square feet
<b>Office Build-out</b>	1,641 square feet
<b>Number of Doors</b>	2 Dock Doors 1 Ramp
<b>Ceiling Height</b>	20' clear
<b>Power</b>	800 amp, 120/208 volts, 3 phase
<b>Location</b>	Convenient access to I-30, I-35E, and Loop 12

## 1628 Terre Colony Court Dallas, TX

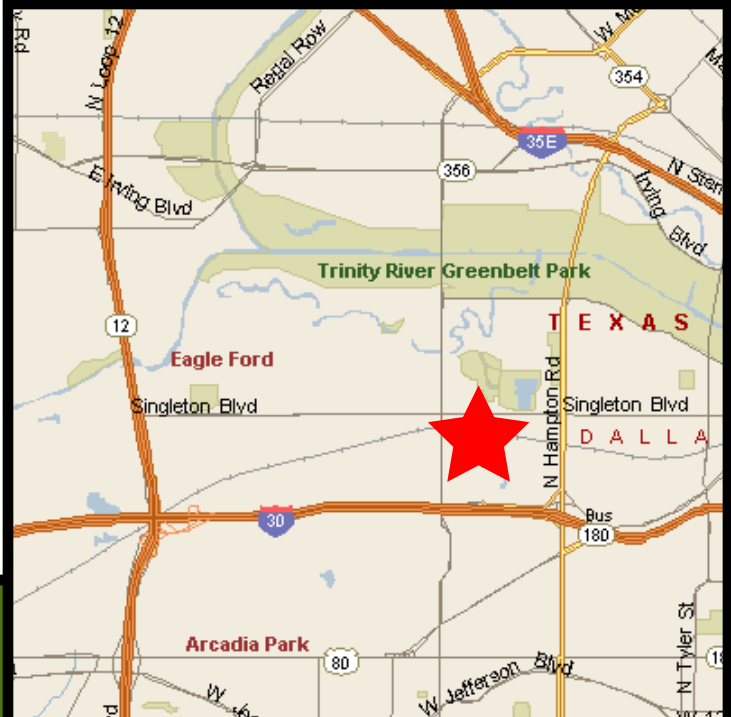

[www.firstindustrial.com](http://www.firstindustrial.com)

### FIRST INDUSTRIAL REALTY TRUST

4505 Excel Parkway Suite 600 Addison, TX 75001

T: (972) 386-4700 F: (972) 386-4540 [www.firstindustrial.com](http://www.firstindustrial.com)



# FOR LEASE 14,849 SF

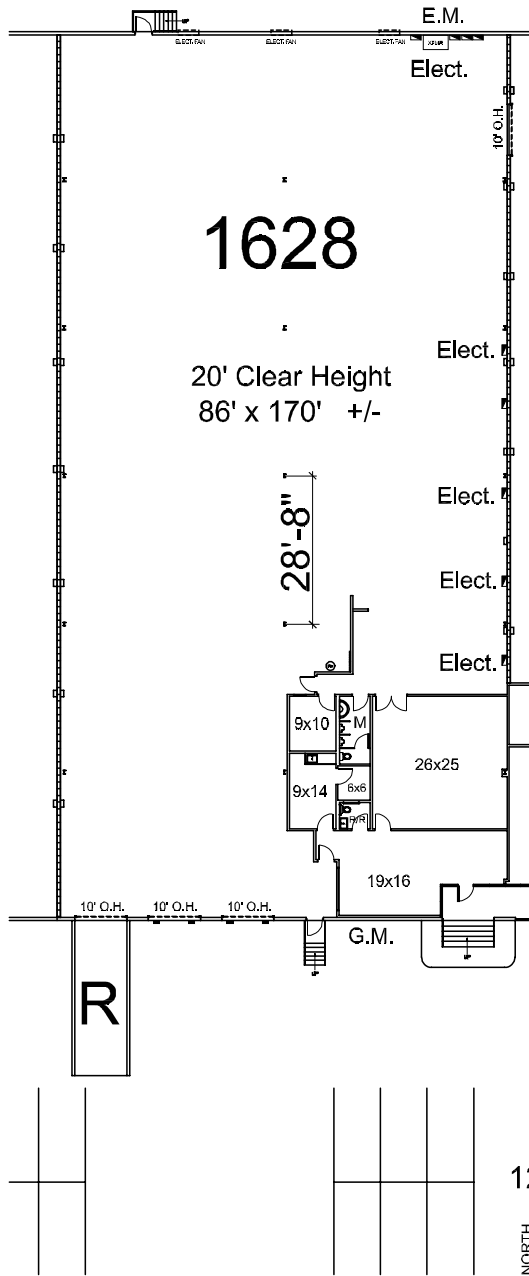

14,849 S.F. Total / 1,641 S.F. Office

## → CONTACT

our exclusive agent:

**NAI Robert Lynn**  
Commercial Real Estate Services, Worldwide.

### **Matt Elliott**

NAI Robert Lynn  
Vice President  
(214) 256-7161  
melliott@robertlynn.com

### **Craig Jones, SIOR**

NAI Robert Lynn  
Executive Vice  
President / Principal  
(214) 256-7110  
cjones@robertlynn.com

All information furnished regarding the property for sale, rental or financing is obtained from sources deemed reliable. No representation is made to the accuracy thereof and is submitted subject to errors, omissions, change of price rental or other conditions, prior sale, lease, or financing, or withdrawal without notice. First Industrial Realty Trust, Inc. represents the Seller in this transaction and as such owes all duties and obligations thereto.

## FIRST INDUSTRIAL REALTY TRUST

4505 Excel Parkway Suite 600 Addison, TX 75001  
T: (972) 386-4700 F: (972) 386-4540 www.firstindustrial.com

