

For Lease

1533 Crescent Drive #102
Carrollton, Texas
21,812 Square Feet

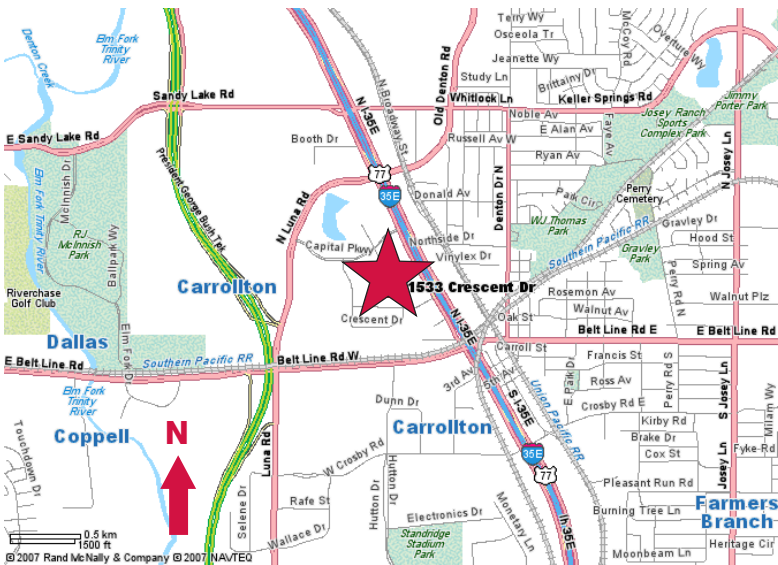

- ± 2,500 SF Office
- ± 22' Clear Height
- 3 Dock High Doors
(1 Ramped & All With Levelers)
- Sprinklered
- Heavy Power
- 45+ Car Parks



contact information:

Mark Miller, SIOR

NAI Robert Lynn

direct 214 256 7119

fax 214 256 7101

email mmiller@robertlynn.com

Adam Curran

NAI Robert Lynn

direct 214 256 7163

fax 214 256 7101

email acurran@robertlynn.com

Becky Miller

NAI Robert Lynn

direct 214 256 7107

fax 214 256 7101

email bmiller@robertlynn.com

NAI Robert Lynn

Commercial Real Estate Services, Worldwide.

For Lease

1533 Crescent Drive #102
Carrollton, Texas
21,812 Square Feet

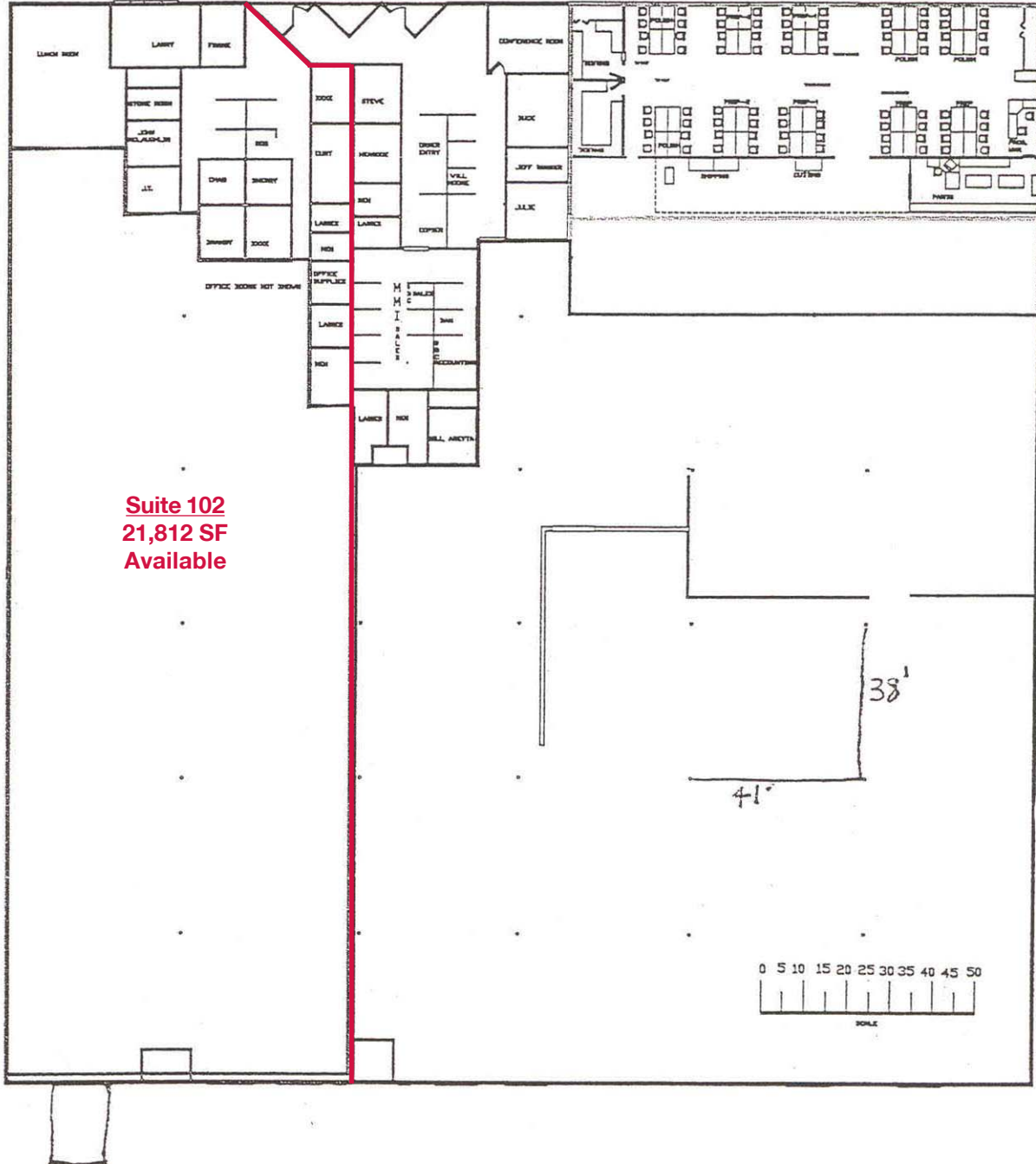

Suite 102
21,812 SF
Available