

# For Lease

1501-1525 Greenview Drive  
Grand Prairie, Texas  
4,890 - 19,470 Square Feet

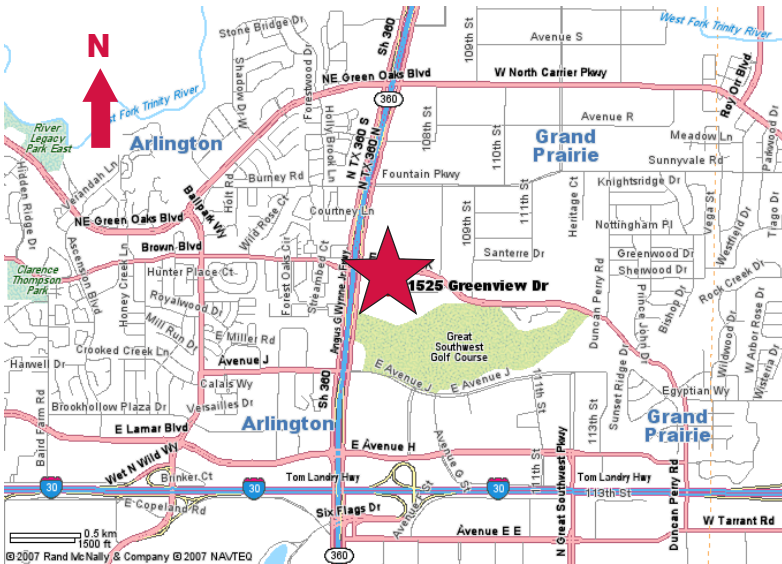

- 1501 Greenview Drive
  - ± 4,890 Total SF
  - ± 814 SF Office
  - ± 18' Clear Height
  - 1 Dock Door
  - All Air-Conditioned
  - Expandable to 19,470 SF
- 1513 Greenview Drive
  - ± 14,580 Total SF
  - ± 1,335 SF Office
  - ± 18' Clear Height
  - 6 Dock Doors (2 Ramped & 1 With Leveler)
  - Divisible to 4,890 SF
  - Expandable to 19,470 SF
- 1525 Greenview Drive
  - ± 14,760 Total SF
  - ± 2,595 SF Office
  - ± 18' Clear Height
  - 5 Dock Doors
  - All Air-Conditioned
  - Divisible to 4,890 SF



contact information:  
**John Lancaster**  
NAI Robert Lynn  
direct 214 256 7162  
email [jlancaster@robertlynn.com](mailto:jlancaster@robertlynn.com)



Commercial Real Estate Services, Worldwide.

**Robert Reese**  
NAI Robert Lynn  
direct 214 256 7166  
email [reese@robertlynn.com](mailto:reese@robertlynn.com)

# For Lease

1501-1525 Greenview Drive  
Grand Prairie, Texas  
4,890 - 19,470 Square Feet

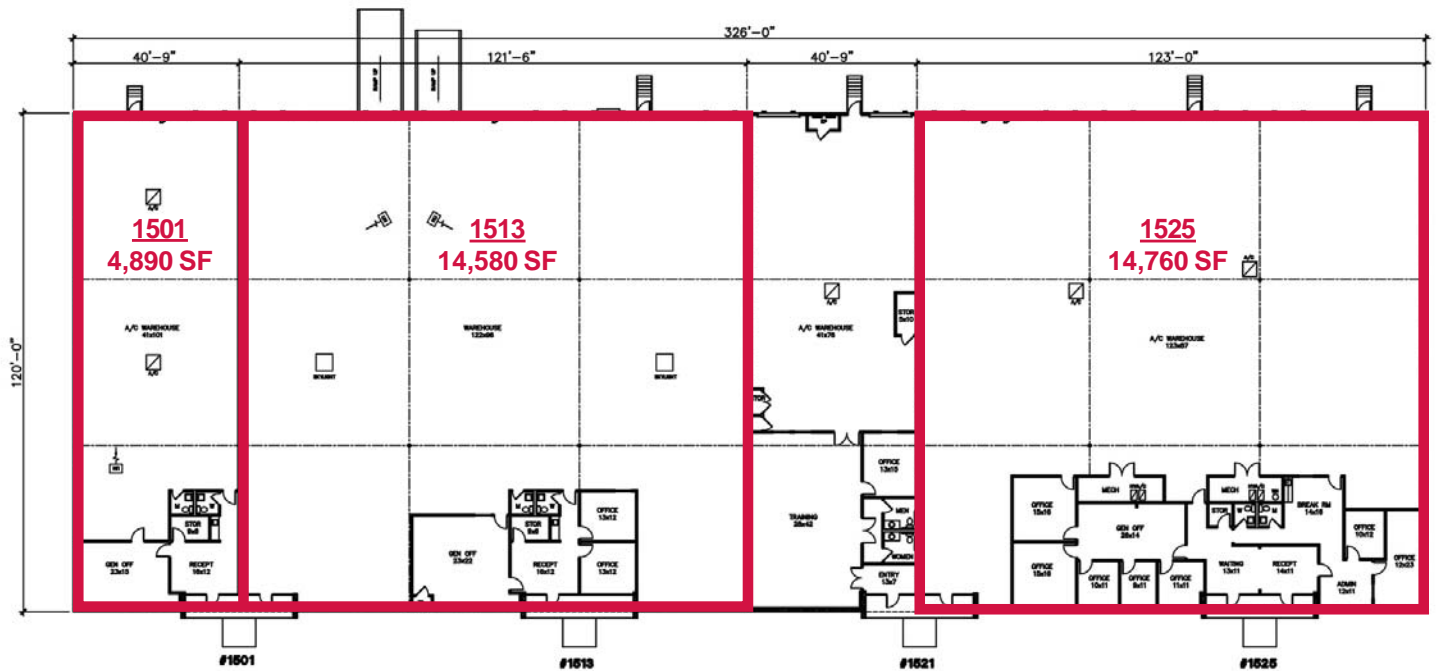

## contact information:

**John Lancaster**

NAI Robert Lynn  
direct 214 256 7162  
fax 214 256 7101  
email [jlancaster@robertlynn.com](mailto:jlancaster@robertlynn.com)

**Robert Reese**

NAI Robert Lynn  
direct 214 256 7166  
fax 214 256 7101  
email [rreese@robertlynn.com](mailto:rreese@robertlynn.com)

**NAI Robert Lynn**  
Commercial Real Estate Services, Worldwide.

Individual Memberships  
SOCIETY OF  
INDUSTRIAL AND  
OFFICE REALTORS®