

For Sublease

1225 N. 28th Avenue, Suite 500
DFW Airport, Texas
100,000 Square Feet



- ± 14,726 SF Office
- ± 24' Clear Height
- 8 Dock High Doors
- 1 Ramped Door
- ESFR Sprinkler System
- Heavy Power
- Foreign Trade Zone
- Great Highway 114 Frontage
- Sublease Through February 2016



contact information:
Mark Miller, SIOR
NAI Robert Lynn
direct 214 256 7119
fax 214 256 7101
email mmiller@robertlynn.com



Commercial Real Estate Services, Worldwide.

Tyson Erwin
NAI Robert Lynn
direct 214 256 7127
fax 214 256 7101
email terwin@robertlynn.com

For Sublease

1225 N. 28th Avenue, Suite 500
DFW Airport, Texas
100,000 Square Feet

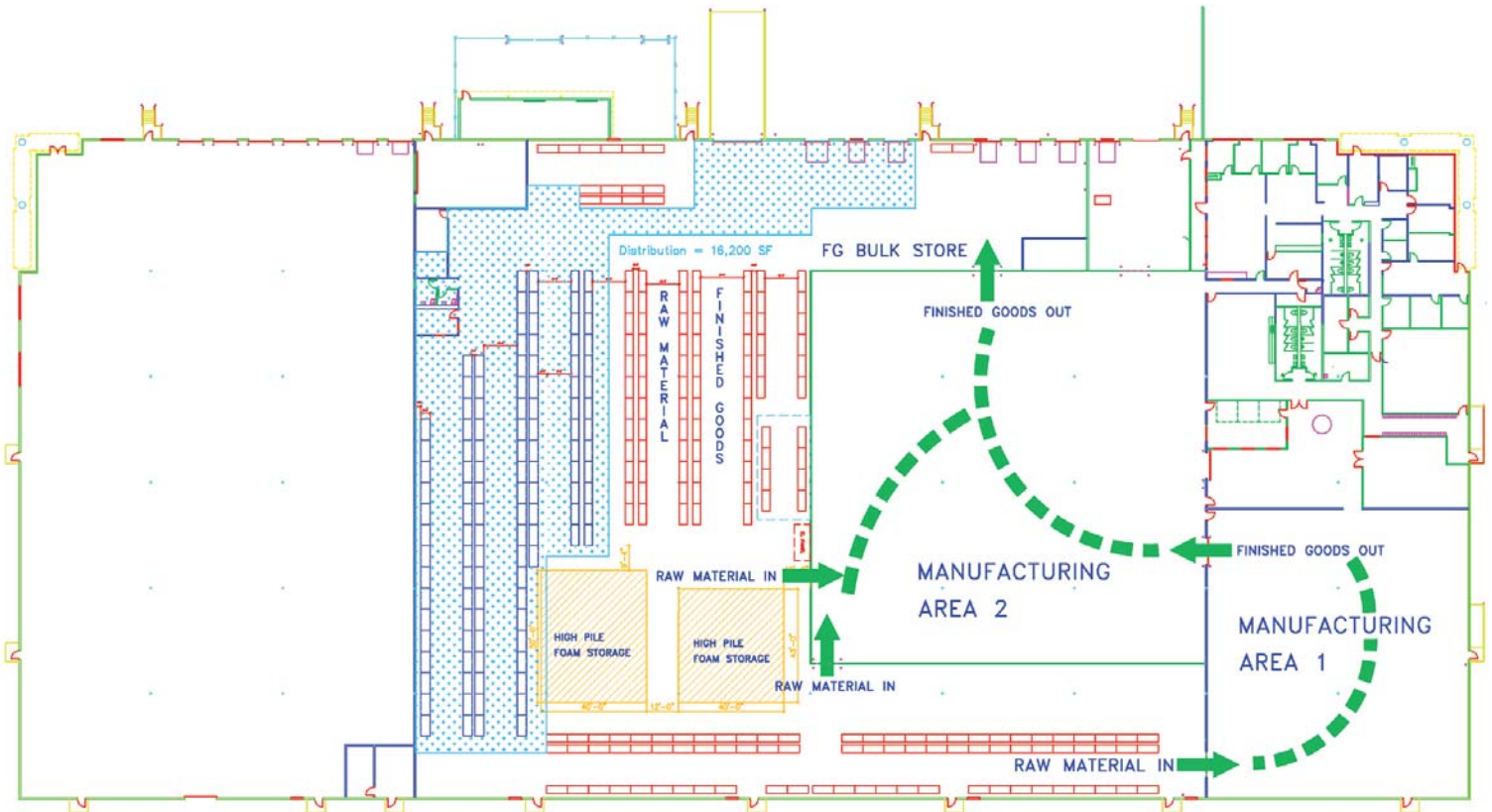

100,000 sf Facility
37,537 sf Manufacturing Area
47,737 sf Warehouse Area
* 31,492 sf Mfg Support
* 16,245 sf Distribution
14,726 sf Office, Common Area, Maintenance Shop

NAI Robert Lynn

Commercial Real Estate Services, Worldwide.

The information contained herein has been given to us by the owner of the property or other sources we deem reliable. We have no reason to doubt its accuracy, but we do not guarantee it. All information should be verified prior to purchase or lease.

Individual Memberships
SOCIETY OF
INDUSTRIAL AND
OFFICE REALTORS®